

INSTALLATION GUIDE

CODELOCKS HEADQUARTERS

Tel: +44 (0) 1635 239645
Fax: +44 (0) 1635 239644
sales@codelocks.co.uk
www.codelocks.co.uk

Helpline, service & spares
Freephone: 0800 393 405

CODELOCKS INC US

Tel: +1 714 979 2900
Fax: +1 714 979 2902
sales@codelocks.us
www.codelocks.us

Helpline, service & spares
Toll free: 1.877.codelock

CODELOCKS (Australia) PTY LTD

Tel: +61 2 9882 1009
Fax: +61 2 9882 6030
sales@codelocks.com.au
www.codelocks.com.au

Helpline, service & spares
Toll free: 1800 052 131



II-KL1000-v3:0151

A Replace existing cam lock with KitLock

- | | | | |
|--------|--|---------|--|
| Step 1 | Remove existing cam lock.
..... | Step 8 | Tighten the lower fixing nut
and upper bolt.
..... |
| Step 2 | Place the 16mm (5/8") template
hole over the hole left by the
cam lock and mark the upper
fixing hole.
..... | Step 9 | Select the cam which suits
your door and frame and
attach it to the square shaft at
the end of the spindle.
..... |
| Step 3 | Drill the 6mm (1/4") fixing hole.
..... | Step 10 | Now check the operation of
the lock using the factory
User Code 2244.
..... |
| Step 4 | Fit the KitLock to the door by
passing the spindle through
the 16mm (5/8") hole.
..... | Step 11 | If the lock is functioning
correctly, CHANGE THE
DEFAULT MASTER
CODE 11335577 and
DEFAULT USER CODE
2244 and program the
lock using the programming
and operating instructions
enclosed. |
| Step 5 | If required, from the inside of
the door, pass either of the
packing pieces over the
spindle to centralise the lock.
..... | | |
| Step 6 | Now secure the lock by threading
the large nut onto the spindle.
..... | | |
| Step 7 | Fit one of the upper fixing bolts
to suit your door thickness. | | |

B New Installation

- | | | | |
|--------|--|--------|--|
| Step 1 | Place template on door and
mark upper 6mm (1/4") hole
and lower 16mm (5/8") hole.
IMPORTANT NOTE: Before
drilling fixing holes, please
ensure the position of the
KitLock when fitted will allow
enough clearance for selected
cam to work. | Step 2 | Drill both fixing holes.
..... |
| | | Step 3 | Continue installation from
step 4 to 11, above. |

KL1000

Installation
Instructions

KitLock
Coded Locker Solutions

SPECIAL NOTES

FITTING INSTRUCTIONS

Please read carefully:

- Before installing the lock, load the batteries and familiarise yourself with the operation and programming.
- The handle will not turn until you enter the factory default Master Code 11335577 or the User Code 2244.
- Please see programming guide to set your own codes.
- Your KitLock is supplied ready to fit to doors up to 19mm ($3/4$ " thick. For doors between 19mm ($3/4$ " and 25mm (1") thick, you will need to install the 28.5mm ($1\ 1/8$ " spare spindle (see below). A 12mm ($1/2$ " spindle is also included for sheet metal doors (see below).

The KitLock can be fitted to:

A Cabinets, cupboards and lockers etc as a direct replacement for existing cam locks.

B It can also be fitted easily to cupboards and cabinets that do not have an existing locking device.

- 1 KitLock
- 2 Upper fixing bolt x 2
- 3 Packer pieces x 3
- 4 Locking nut
- 5 Cams x 2
- 6 Cam fixing bolt

Batteries – 2 x 1.5V AAA
Template x 1

1. Remove the lower 2 fixing screws.
2. Remove cover plate, spindle and threaded shaft.
3. Replace with spare spindle and threaded shaft.
4. Replace cover plate.

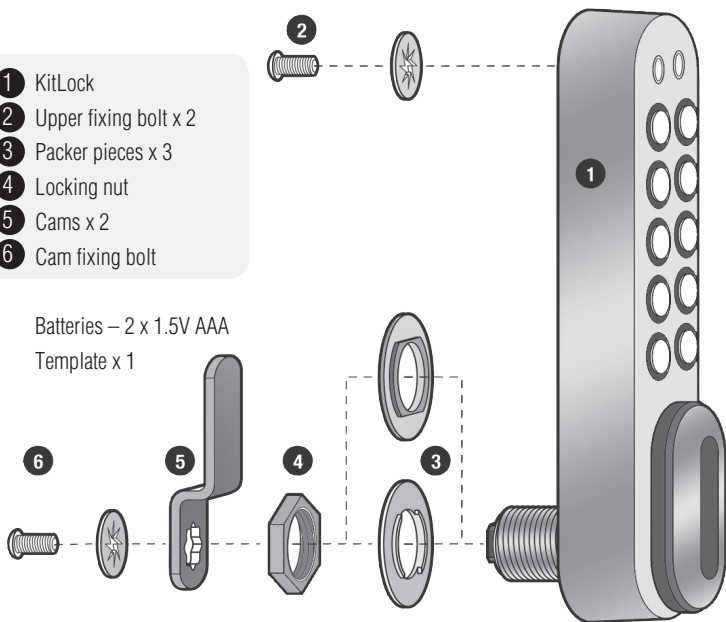
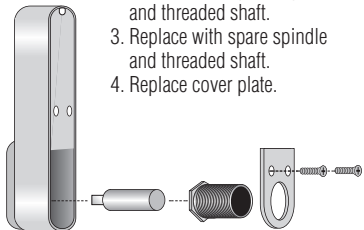

LOCKED

OPEN



KL1000 can be supplied vertically, left or right hand horizontal.



Please see installation guide on reverse